

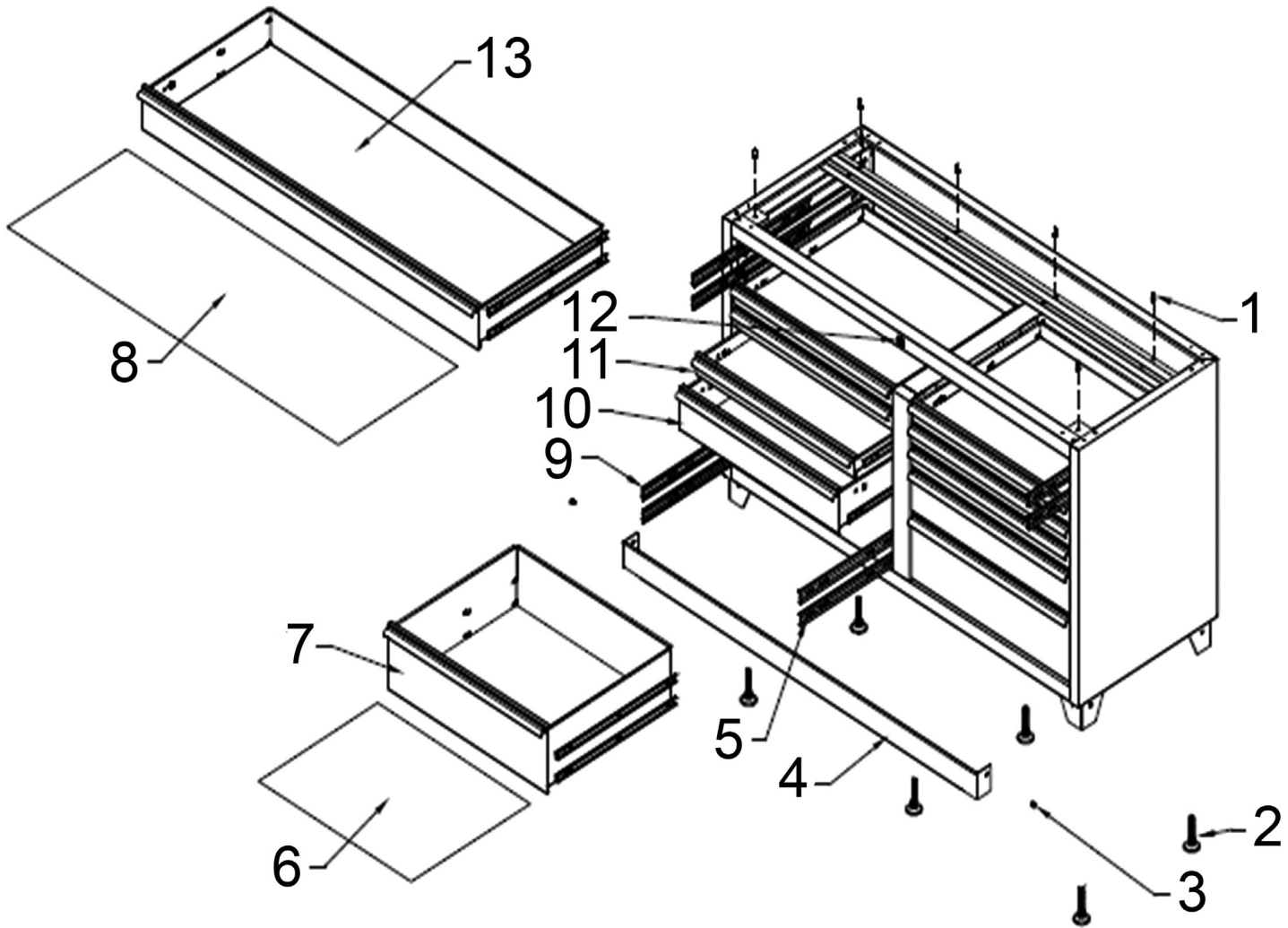

Parts Information:  
**Premier™ Heavy-Duty Modular Floor  
Cabinet 11 Drawer 1550mm  
Model No: APMS04**



Item	Part No.	Description	Qty
1	APMS-320122	Bolt, Hex Flange M4.8 x 25mm	6
2	APMS-313004	Adjustable Foot	6
3	MSP612.SB	Machine Screw Pan Head Phillips M6 x 12mm Black	2
4	APMS-221785	Cabinet Support (Kick Plate)	1
5	APMS-300324	Slide, Right	14
6	APMS-551583	Drawer Liner 667 x 545mm	10
7	APMS04-LD	Large Drawer	2
8	APMS-551582	Drawer Liner 1442 x 545mm	1
9	APMS-300323	Slide, Left	14

Item	Part No.	Description	Qty
10	APMS04-MD	Medium Drawer	2
11	APMS04-SD	Small Drawer	6
12	PTB-304007	Lock and Key ( <b>Number 1201</b> )	1
12	PTB-304007A	Lock and Key ( <b>Number 1202</b> )	--
12	PTB-304007B	Lock and Key ( <b>Number 1203</b> )	--
12	PTB-304007C	Lock and Key ( <b>Number 1204</b> )	--
13	APMS04-TLD	Top Long Drawer	1
--	PTB-310157	Sealey Zinc Badge (Not Shown)	1
--	PTB-310158	Premier Zinc Badge (Not Shown)	1

**NOTE:** It is our policy to continually improve products and as such we reserve the right to alter data, specifications and component parts without prior notice. There may be alternative versions of this product, please contact us should you require this information.

**IMPORTANT:** No liability is accepted for incorrect use of product. Spare parts must be fitted by a competent person

**WARRANTY:** Guarantee is 12 months from purchase date, proof of which will be required for any claim.